

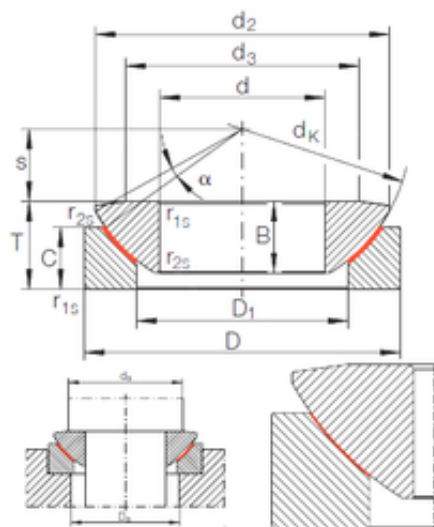

IOR Bearing Manufacturing Co.,Ltd



INA GE 15 AW plain bearings

Bearing No. GE 15 AW

Size	15x42x15 mm
Bore Diameter	15 mm
Outer Diameter	42 mm
Width	15 mm
d	15 mm
D	42 mm
T	15 mm
B	10,7 mm
C	11 mm
d2	38,9 mm
d3	29 mm
dk	45 mm
r1 min.	0,6 mm
r2 min.	0,2 mm
D1	24 mm
S	10 mm
da max	29 mm
Da min	26 mm
Angle	7 °
Weight	0,12 Kg
Basic dynamic load rating (C)	156 kN

GE 15 AW Bearing 2D drawings and 3D CAD models